



## 3D VIEW

**ACME**

ACMF  
PO BOX 101 760 NORTH SHORE 0745  
TEL: 09 214 3236 FAX: 09 444 2142  
68 ELLICE ROAD, GLENFIELD



**FINesse**  
Precision Meets Elegance

**BALUSTRADO SYSTEM**

Copyright - ACMF No part of this document may be reproduced, stored in a retrieval system in any form or transmitted by any means without prior permission in writing of ACMF. All discrepancies shall be referred to ACMF immediately.

DATE : 14/04/2025

SCALE : NTS

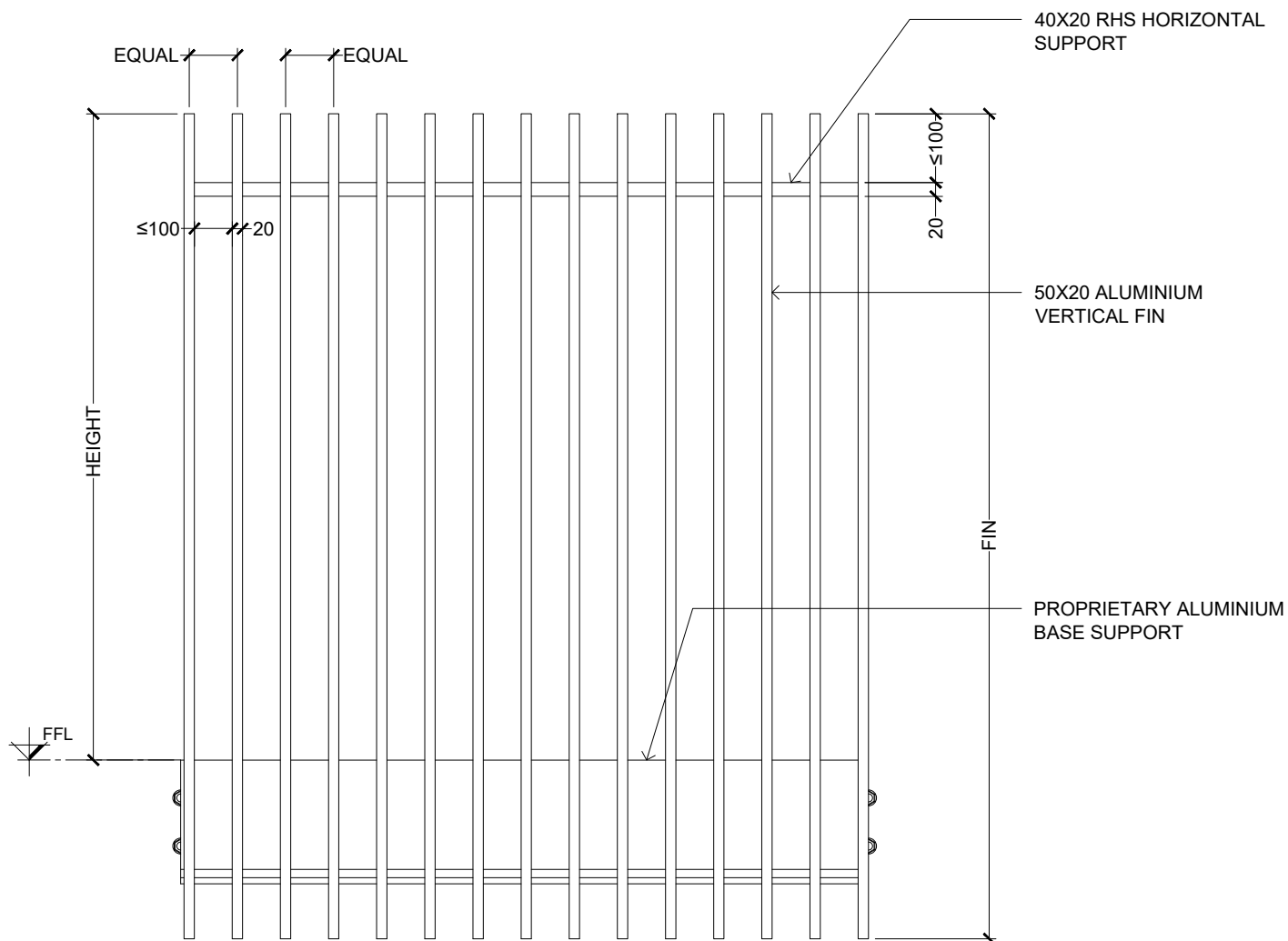

FRONT ELEVATION  
SCALE 1 : 10

#### TECHNICAL DATA

DESCRIPTION :	FINesse - FIN BALUSTRADE SYSTEM
MATERIAL :	ALUMINIUM ALLOY 6061-T6
TYPICAL HEIGHT :	1000 MM / 1100 MM FROM FFL (REFER TO NZBC F4/AS1)
FIXING TYPE OPTIONS :	SIDE FIX

**ACME**

ACMF  
PO BOX 101 760 NORTH SHORE 0745  
TEL: 09 214 3236 FAX: 09 444 2142  
68 ELLICE ROAD, GLENFIELD

**FINesse**  
Precision Meets Elegance

**BALUSTRADE SYSTEM**

Copyright - ACMF No part of this document may be reproduced, stored in a retrieval system in any form or transmitted by any means without prior permission in writing of ACMF. All discrepancies shall be referred to ACMF immediately.

DATE : 14/04/2025

SCALE : NTS

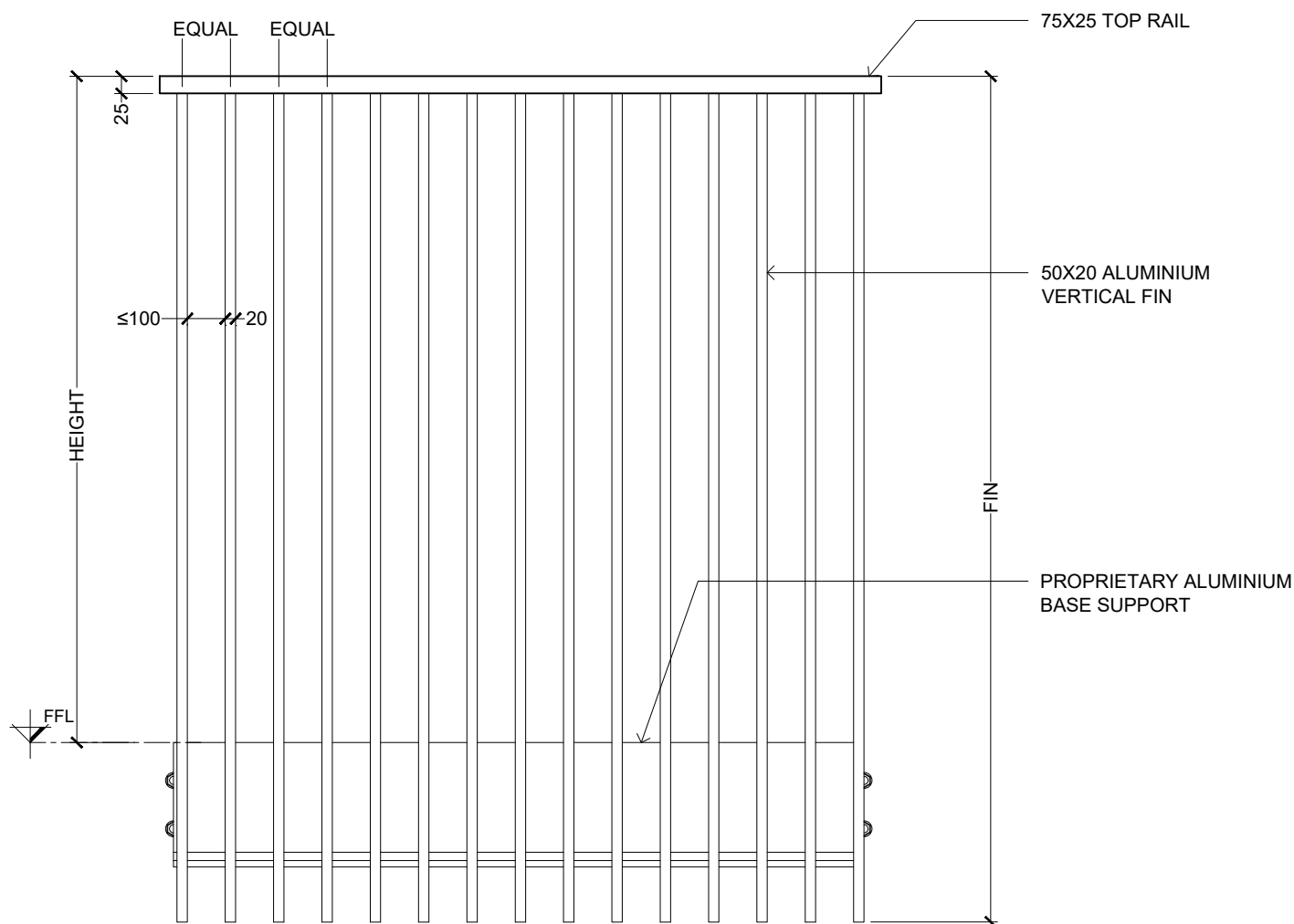

FRONT ELEVATION  
SCALE 1 : 10

#### TECHNICAL DATA

DESCRIPTION :	FINesse-FIN BALUSTRADE SYSTEM W/ TOP RAIL
MATERIAL :	ALUMINIUM ALLOY 6061-T6
TYPICAL HEIGHT :	1000 MM / 1100 MM FROM FFL (REFER TO NZBC F4/AS1)
FIXING TYPE OPTIONS :	SIDE FIX

**ACME**

ACMF  
PO BOX 101 760 NORTH SHORE 0745  
TEL: 09 214 3236 FAX: 09 444 2142  
68 ELLICE ROAD, GLENFIELD

**FINesse**  
Precision Meets Elegance

**BALUSTRADE SYSTEM**

Copyright - ACMF No part of this document may be reproduced, stored in a retrieval system in any form or transmitted by any means without prior permission in writing of ACMF. All discrepancies shall be referred to ACMF immediately.

DATE : 14/04/2025

SCALE : NTS

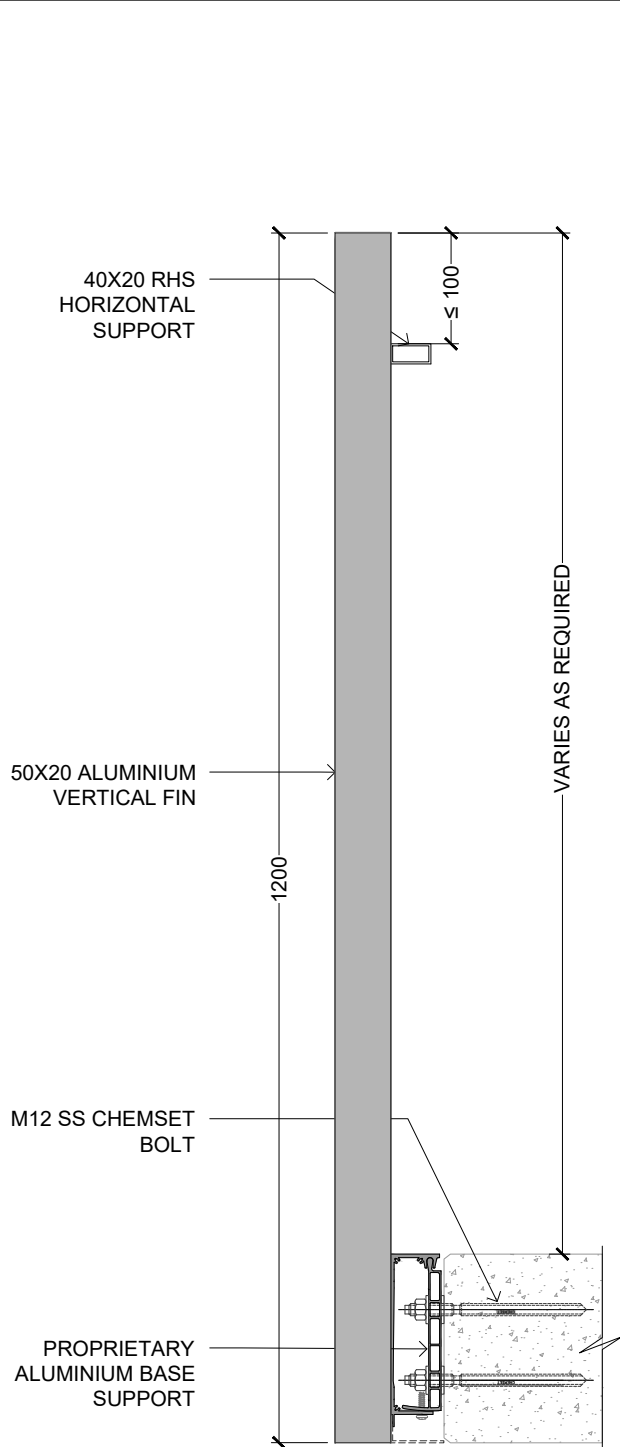

SECTION DETAIL  
SCALE 1 : 7.5

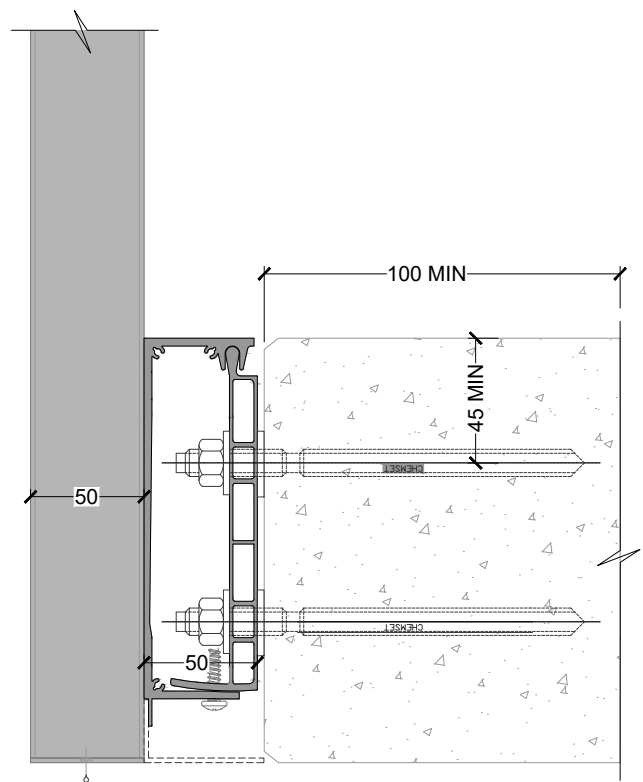
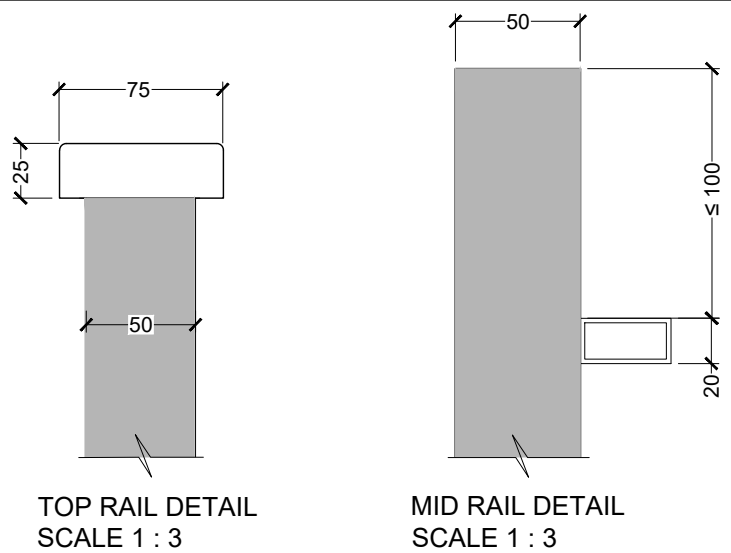

**ACME**

ACMF  
PO BOX 101 760 NORTH SHORE 0745  
TEL: 09 214 3236 FAX: 09 444 2142  
68 ELLICE ROAD, GLENFIELD



**FINesse**  
Precision Meets Elegance

**BALUSTRADE SYSTEM**

Copyright - ACMF No part of this document may be reproduced, stored in a retrieval system in any form or transmitted by any means without prior permission in writing of ACMF. All discrepancies shall be referred to ACMF immediately.

DATE : 14/04/2025

SCALE : NTS

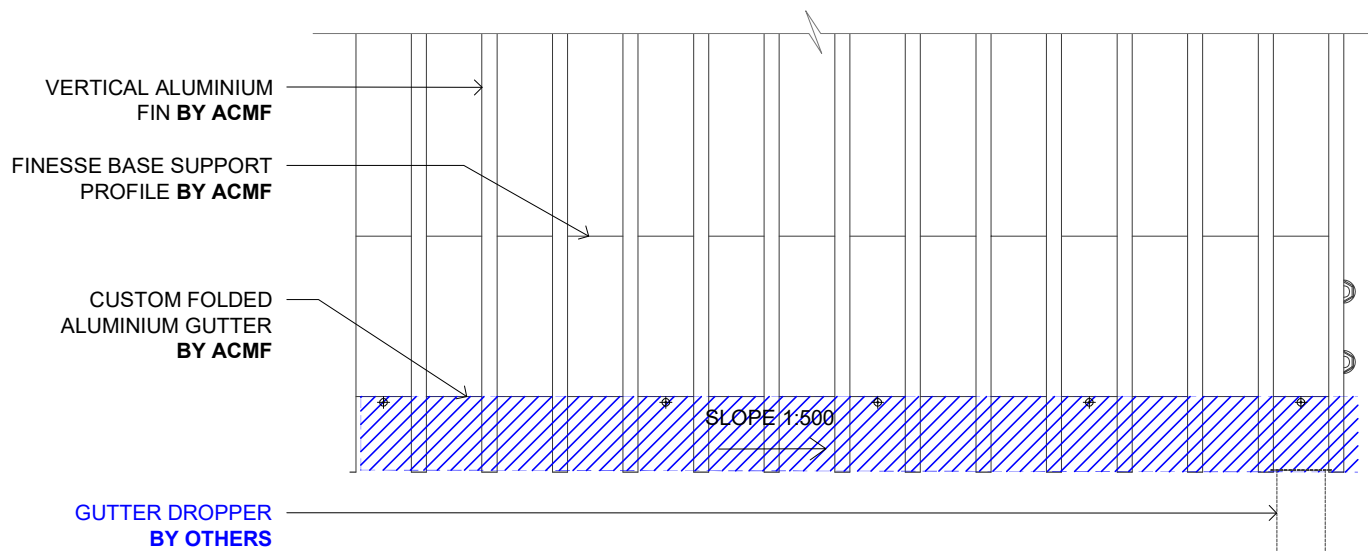

FIN GUTTER ELEVATION  
SCALE 1 : 7.5

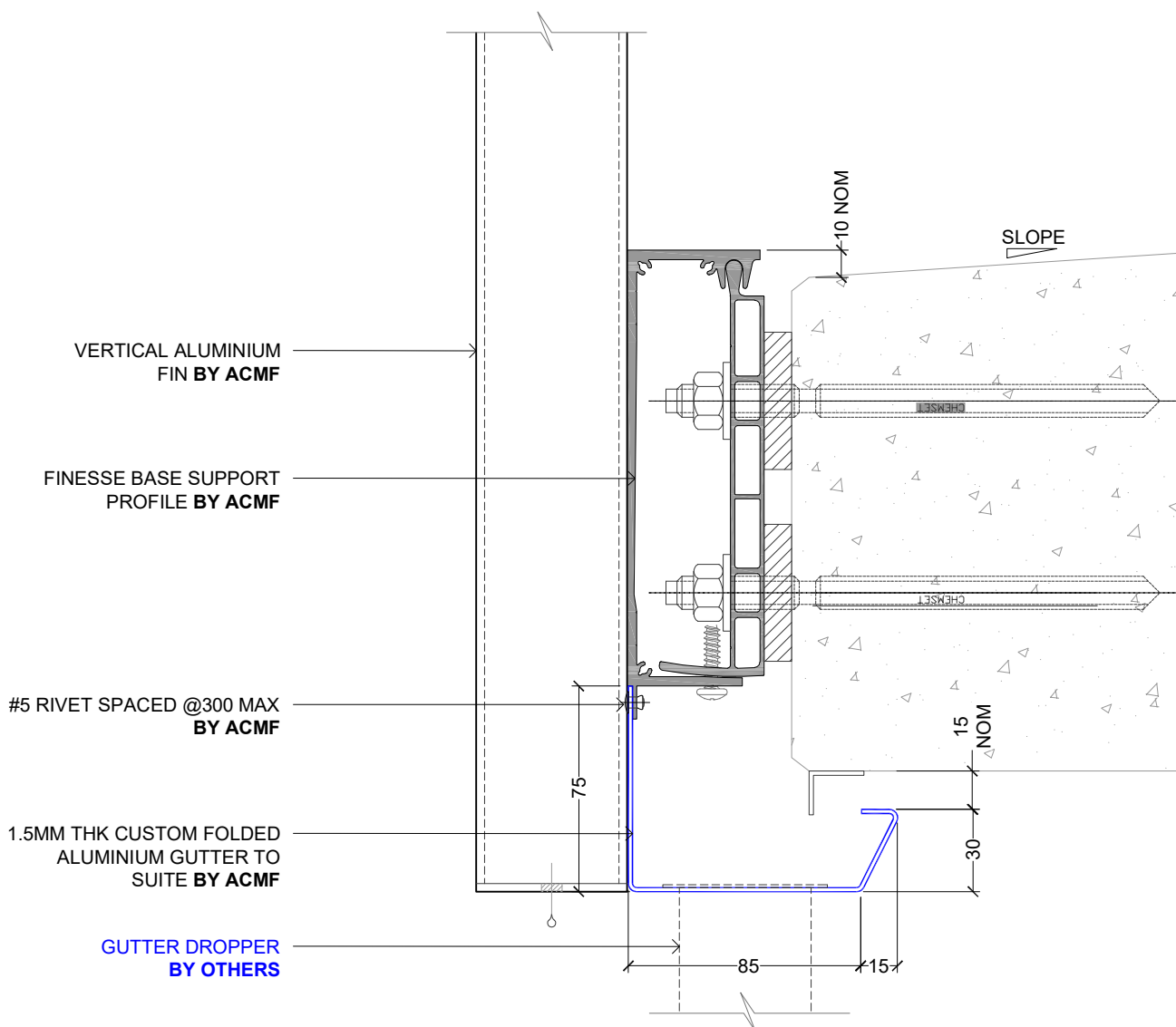

FIN GUTTER DETAIL  
SCALE 1 : 2.5

**ACMF**

ACMF  
PO BOX 101 760 NORTH SHORE 0745  
TEL: 09 214 3236 FAX: 09 444 2142  
68 ELLICE ROAD, GLENFIELD

**FINesse**  
Precision Meets Elegance

**BALUSTRADE SYSTEM**

Copyright - ACMF No part of this document may be reproduced, stored in a retrieval system in any form or transmitted by any means without prior permission in writing of ACMF. All discrepancies shall be referred to ACMF immediately.

DATE : 14/04/2025

SCALE : NTS

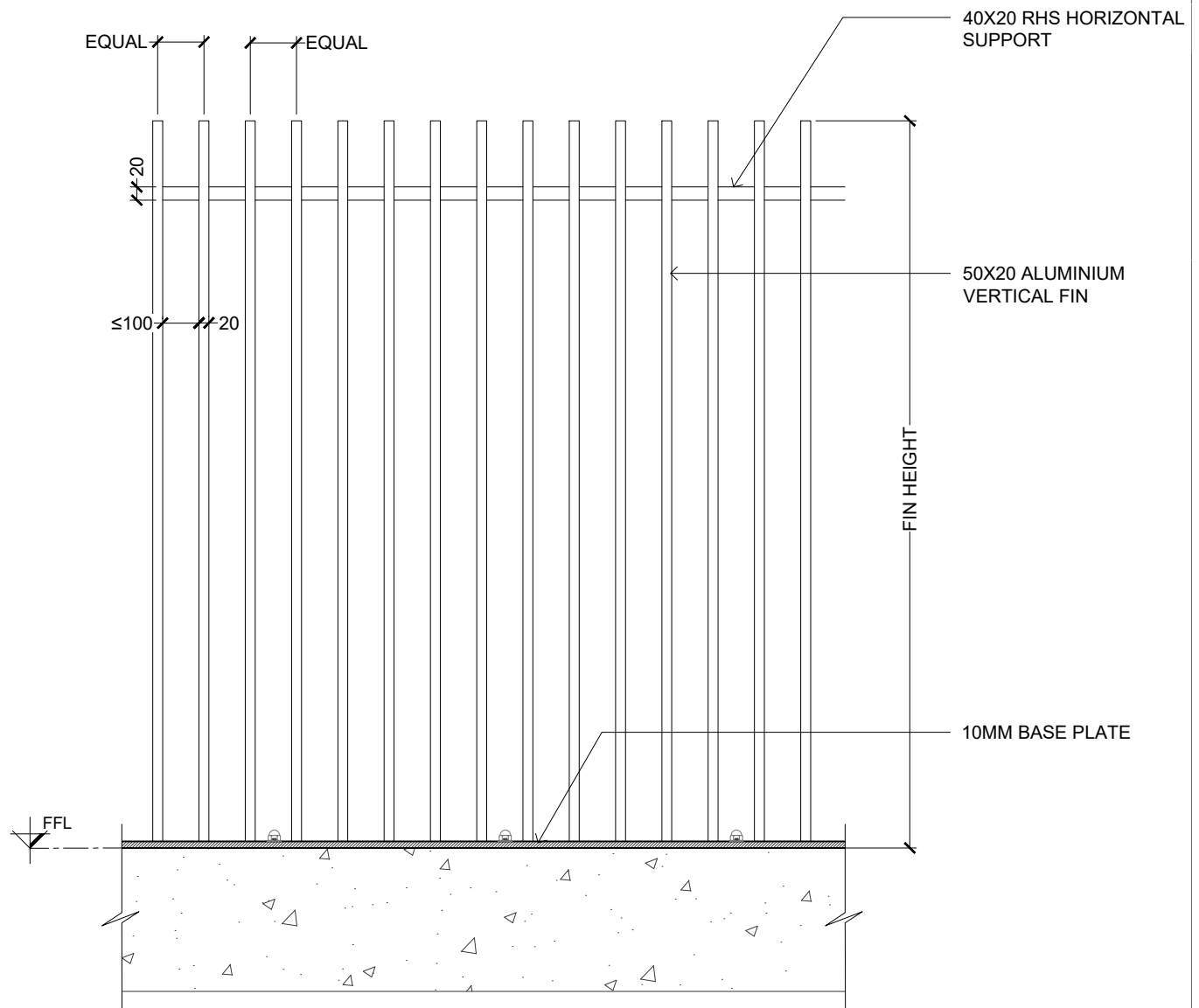

FRONT ELEVATION  
SCALE 1 : 10

#### TECHNICAL DATA

DESCRIPTION :	FINesse - FIN BALUSTRADE SYSTEM
MATERIAL :	ALUMINIUM ALLOY 6061-T6
TYPICAL HEIGHT :	1000 MM / 1100 MM FROM FFL (REFER TO NZBC F4/AS1)
FIXING TYPE OPTIONS :	TOP FIX

**ACME**

ACMF  
PO BOX 101 760 NORTH SHORE 0745  
TEL: 09 214 3236 FAX: 09 444 2142  
68 ELLICE ROAD, GLENFIELD

**FINesse**  
Precision Meets Elegance

**BALUSTRADE SYSTEM**

Copyright - ACMF No part of this document may be reproduced, stored in a retrieval system in any form or transmitted by any means without prior permission in writing of ACMF. All discrepancies shall be referred to ACMF immediately.

DATE : 14/04/2025

SCALE : NTS

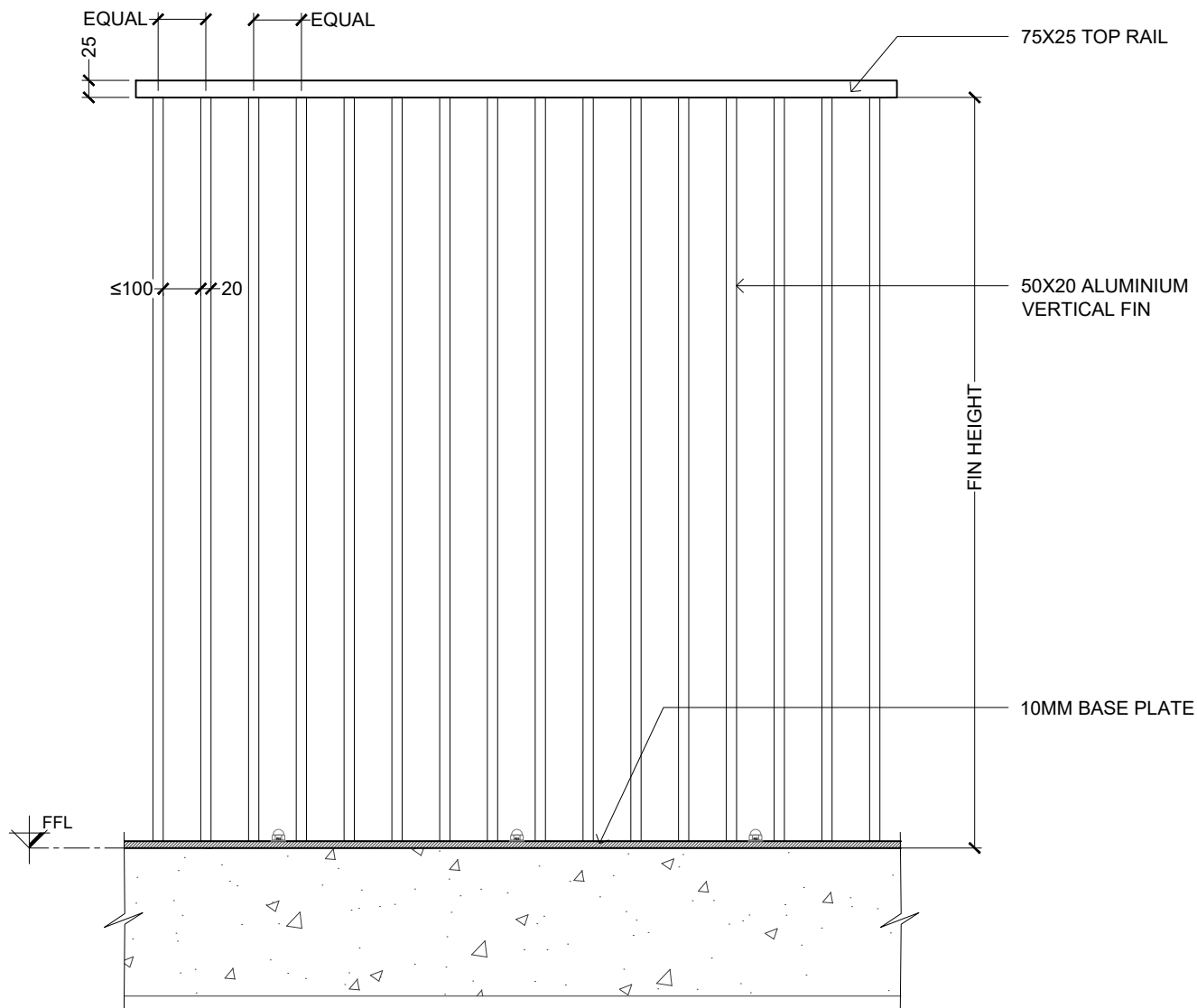

FRONT ELEVATION  
SCALE 1 : 10

#### TECHNICAL DATA

DESCRIPTION :	FINesse - FIN BALUSTRADE SYSTEM W/ TOP RAIL
MATERIAL :	ALUMINIUM ALLOY 6061-T6
TYPICAL HEIGHT :	1000 MM / 1100 MM FROM FFL (REFER TO NZBC F4/AS1)
FIXING TYPE OPTIONS :	TOP FIX

**ACME**

ACMF  
PO BOX 101 760 NORTH SHORE 0745  
TEL: 09 214 3236 FAX: 09 444 2142  
68 ELLICE ROAD, GLENFIELD

**FINesse**  
Precision Meets Elegance

**BALUSTRADE SYSTEM**

Copyright - ACMF No part of this document may be reproduced, stored in a retrieval system in any form or transmitted by any means without prior permission in writing of ACMF. All discrepancies shall be referred to ACMF immediately.

DATE : 14/04/2025

SCALE : NTS

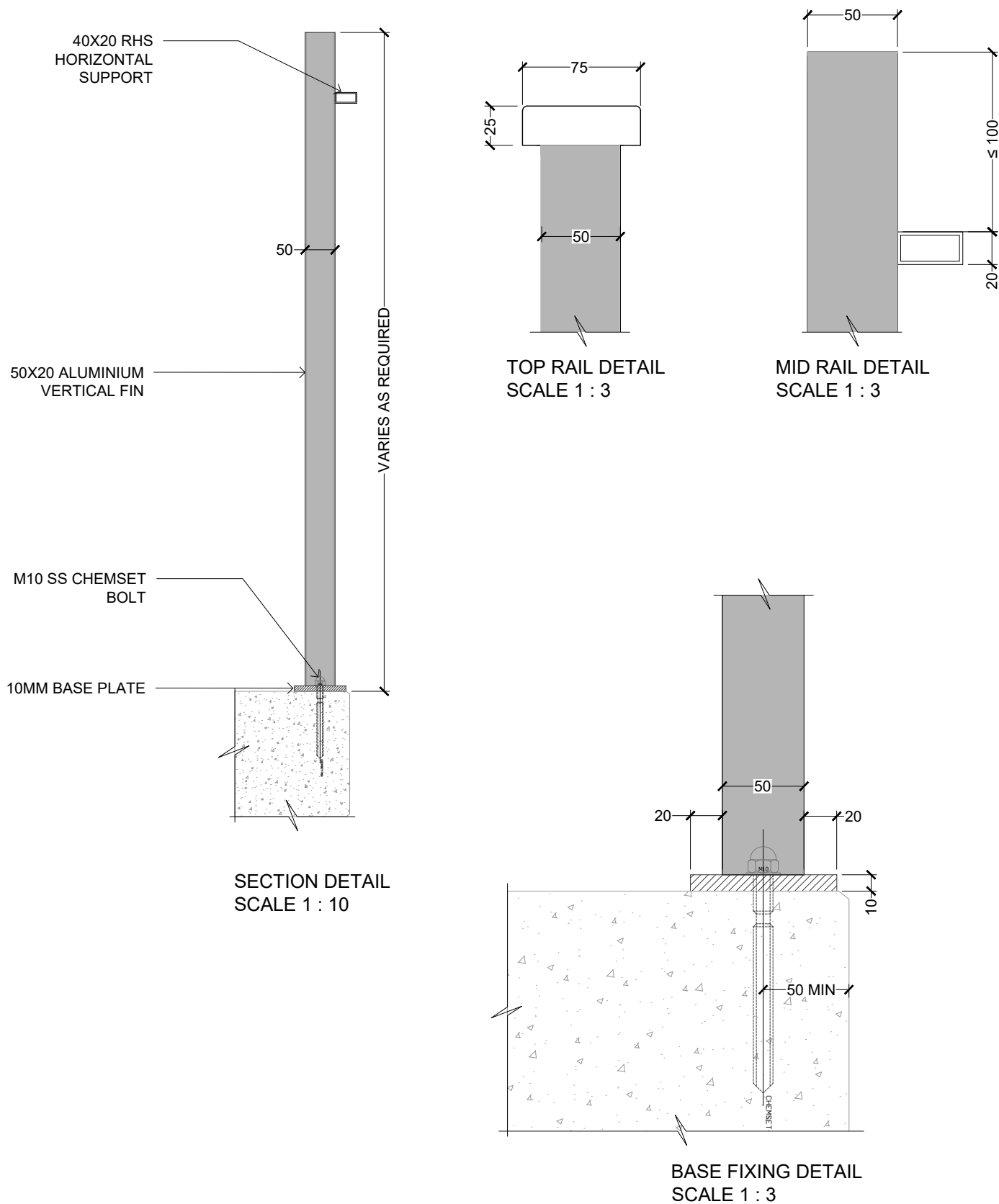

**ACMF**

ACMF  
PO BOX 101 760 NORTH SHORE 0745  
TEL: 09 214 3236 FAX: 09 444 2142  
68 ELLICE ROAD, GLENFIELD



**FINesse**  
Precision Meets Elegance

**BALUSTRADE SYSTEM**

Copyright - ACMF No part of this document may be reproduced, stored in a retrieval system in any form or transmitted by any means without prior permission in writing of ACMF. All discrepancies shall be referred to ACMF immediately.

DATE : 14/04/2025

SCALE : NTS

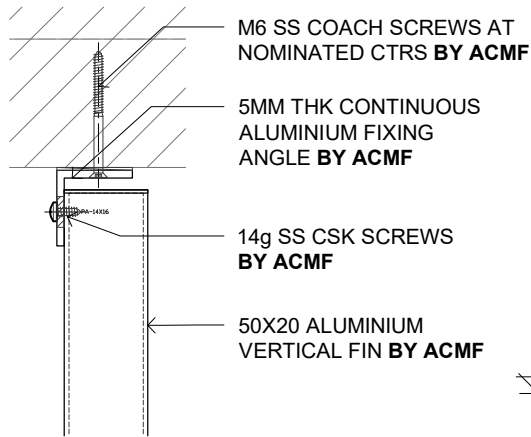

TOP FIXING DETAIL  
SCALE 1 : 5

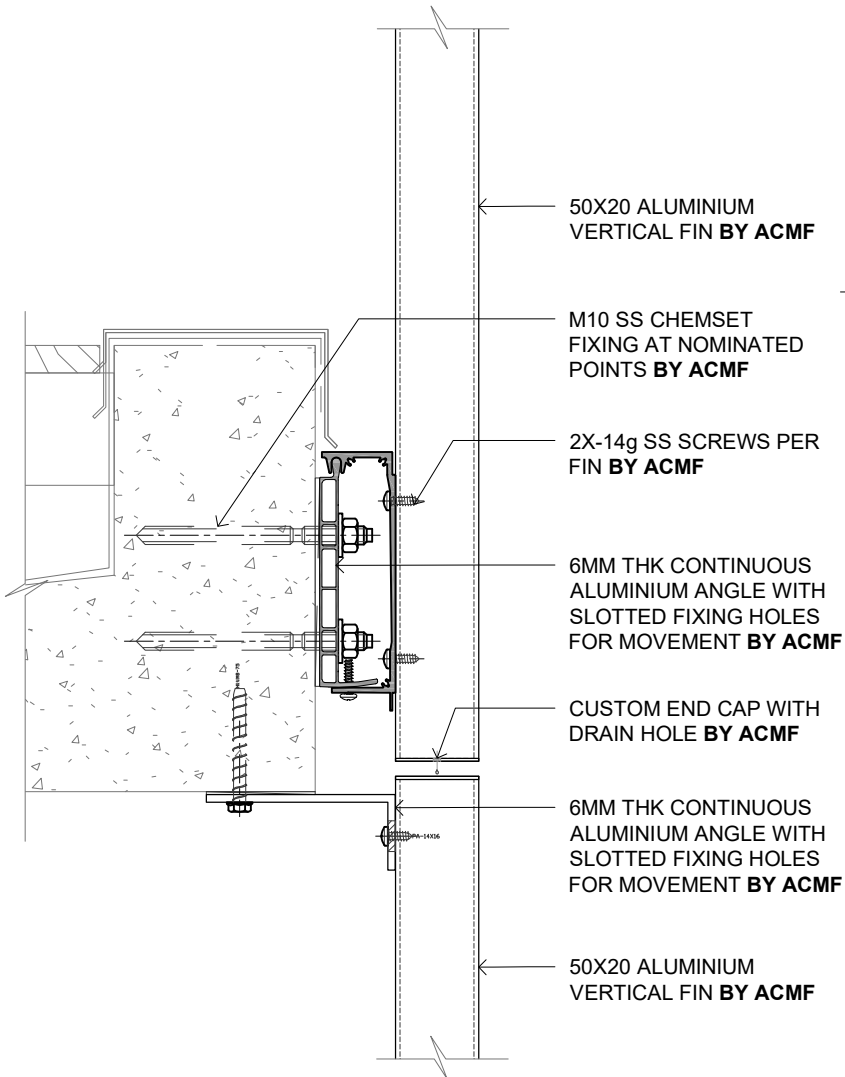

BASE FIXING DETAIL  
SCALE 1 : 5

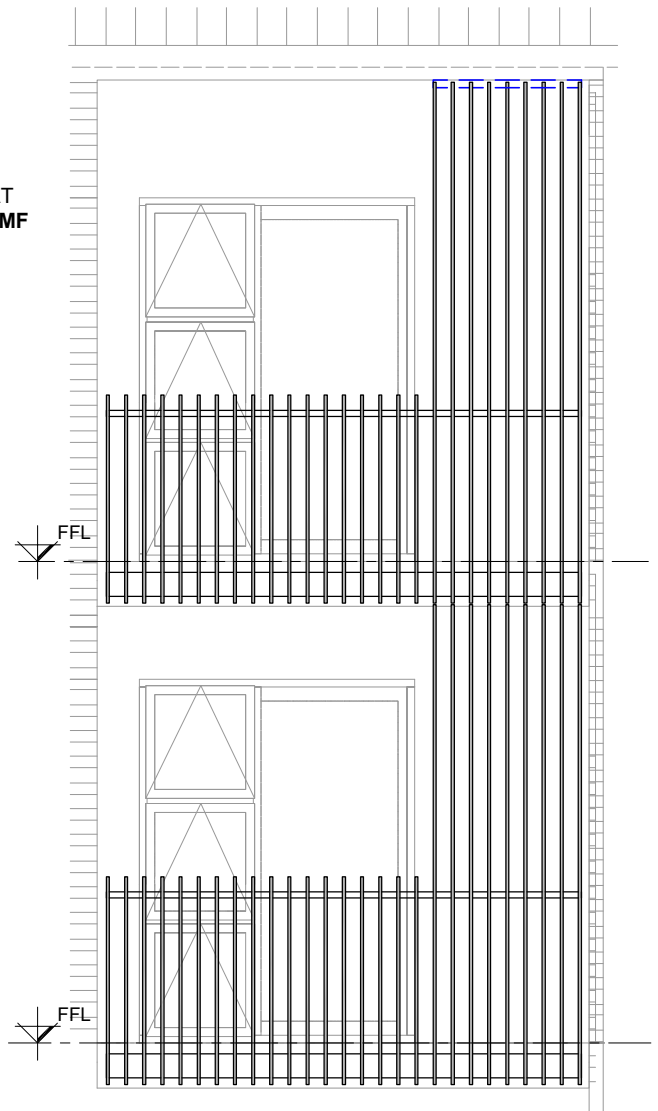

FRONT ELEVATION  
SCALE 1 : 50

FULL FIN BALUSTRADE DETAIL

**ACME**

ACMF - SOLAR EDGE  
PO BOX 101 760 NORTH SHORE 0745  
TEL: 09 214 3236 FAX: 09 444 2142  
68 ELLICE ROAD, GLENFIELD

**FINesse**  
Precision Meets Elegance

Copyright - ACMF No part of this document may be reproduced, stored in a retrieval system in any form or transmitted by any means without prior permission in writing of ACMF. All discrepancies shall be referred to ACMF immediately.

DATE : 22/05/2025

SCALE : NTS