

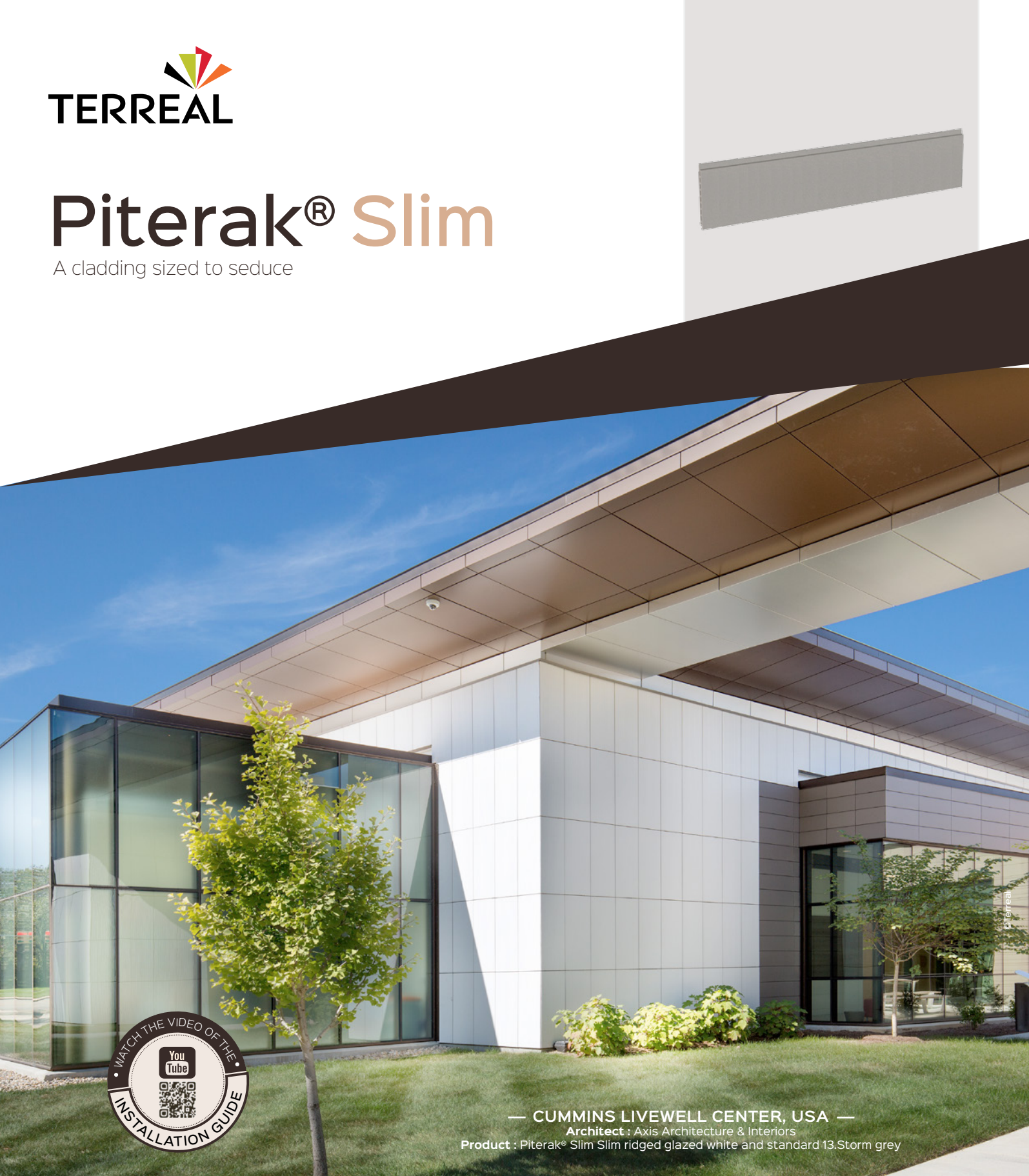

Piterak® Slim

A cladding sized to seduce



— CUMMINS LIVEWELL CENTER, USA —

Architect : Axis Architecture & Interiors

Product : Piterak® Slim Slim ridged glazed white and standard 13.Storm grey

ADVANTAGES

- Large length terracotta cladding : up to 180 cm
- Height from 20 to 60 cm
- Many customization possibilities : colour, finish, shape
- Choice of installation : horizontal or vertical
- High impact performance
- Maintenance free and durability

Piterak® Slim

Piterak® Slim is a large size terracotta rainscreen cladding with overlapping horizontal joints. It is installed with clips fixed on vertical profiles. Used with the V-Clip® system, it is officially approved for vertical installation. Piterak® Slim is tough, rated Q4 for impact resistance and versatile with large range of colours standards or glazed and custom possibilities.

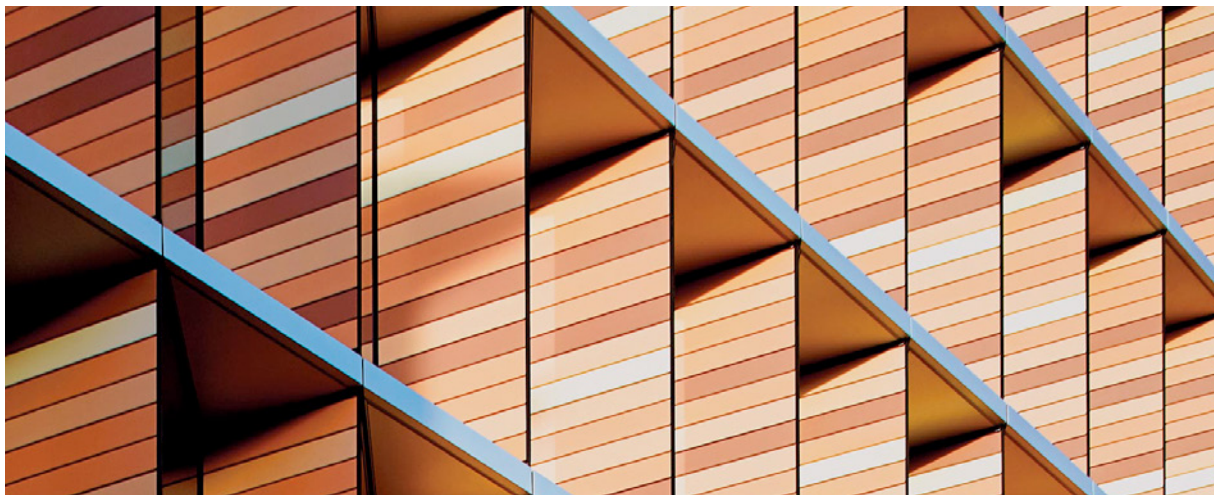

NEW

Large size
CLADDING

From 20 to 60 cm height and up to 180 cm length, Piterak® Slim expands to offer a great modularity and improve terracotta façade potential.

Characteristics

STANDARDS DIMENSIONS

| PRODUCT | MODULE H X L X TH. mm | DIMENSIONS H X L X TH. mm | WEIGHT Unit kg | IMPACT RESISTANCE* | WIND RESISTANCE | | |
|---------------|-----------------------------|---------------------------------|-------------------|-----------------------|--------------------|---------------------|----------|
| | | | | | Standard* | Reinforced | |
| PITERAK® SLIM | 20 | 200 x 1810 | 214 x 1800 x 30 | 17,5 | Q4 | 1578 up to 2359 Pa* | 1945 Pa* |
| | 25 | 250 x 1810 | 264 x 1800 x 30 | 21,8 | Q4 | | |
| | 30 | 300 x 1810 | 314 x 1800 x 30 | 26,2 | Q4 | | |
| | 40 | 400 x 1810 | 414 x 1800 x 30 | 35 | Q4 | 962 up to 1465 Pa* | - |
| | 50 | 500 x 1810 | 514 x 1800 x 30 | 43,7 | Q4 | | |
| | 60 | 600 x 1810 | 614 x 1800 x 30 | 52,4 | Q4 | | |

H =Height ; L=Length ; Th.=Thickness

*Maximum resistance reached with reinforced installation. Up to Q3 for ridged and grooved finishes.



INSTALLATION PROPERTIES

- **Product under technical assesment :** French CSTB and BBA
- **Substrate type :** concrete wall, coated masonry, and framed walls (18 mm)
- **Primary framework:** corrosion resistant metal
- **Installation :** horizontal, vertical (with V-clip® system), soffit (H. max 40 cm; L. max 150 cm with reinforced profile installation)
- **Impact resistance :** Q4 (Q3 for ridged and grooved finishes)
- **Seismic performance,** approved for French categories zone IV, buildings 4 with insulation 240 mm max
- **Fire resistant**
- **Thermal conductivity :** 0.4 to 0.6 W / mK
- **Solar absorption coef. :** 50 to 90% (depending on colour)



CUSTOM...
your cladding



TERREAL works with architects to customize its façade products. With the modularity of the Piterak® Slim, you can imagine new facades and develop specific shape for your projects.

Installation

GENERAL INFORMATION

- **Panels installed with clips** on a metal vertical framework fixed to the wall
- **The vertical uprights** are aligned with the open joints. Their shape drains rainwater in order to protect both the wall and the insulation
- **Very simple** to replace one broken panel
- **Air gap for ventilation** minimum 20mm
- **Vertical joints** : 10 to 20 mm
- **45° mitre** available from factory

WIDE VARIETY OF INSTALLATION

Installation on metal framework



Installation on wood framework



Vertical installation (V-clip® system)

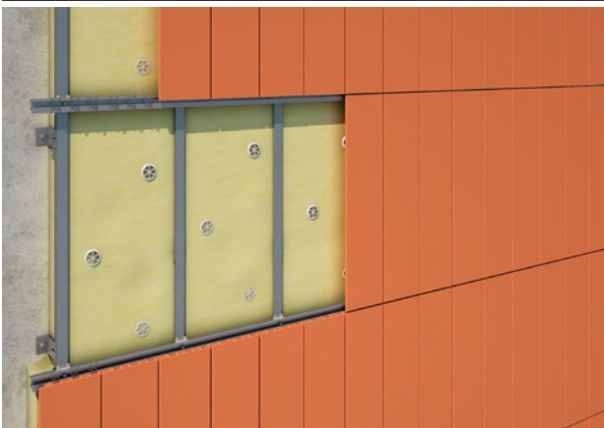

Soffit installation



 **ZOOM ON**

Our you tube
CHANNEL



Watch our installation guide video on our Youtube channel.

<https://youtu.be/HmVP1cOxh88>

6
HEIGHTS

Q4
IMPACT RESISTANCE

DURABLE
MAINTENANCE FREE

MODULAR
INSTALLATION

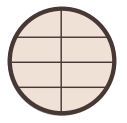
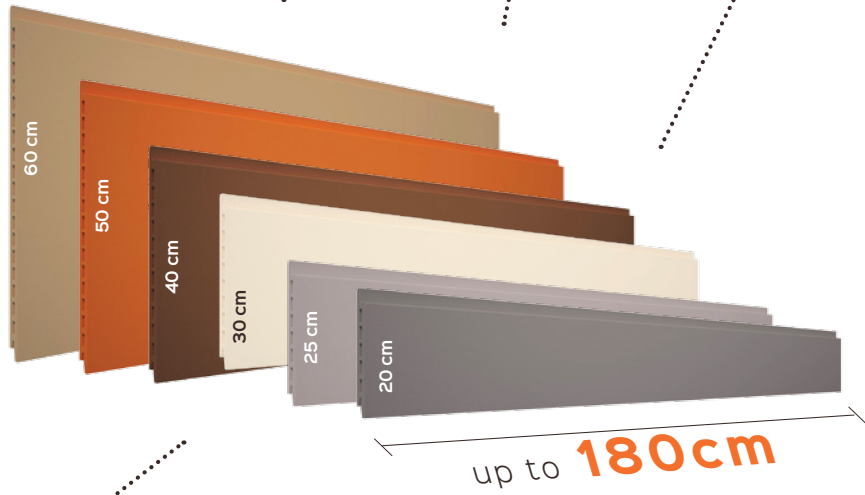

Horizontal

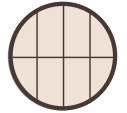

Vertical

3
FINISHES

13
COLOURS

3
SKINS

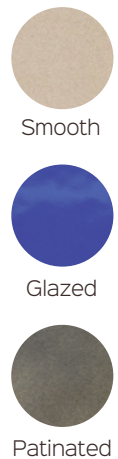
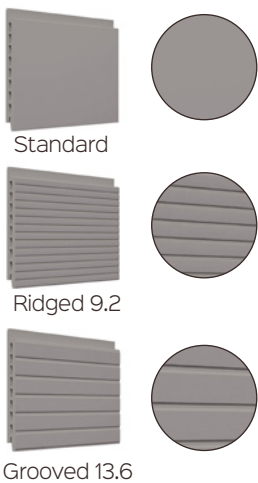

Colours

SMOOTH RANGE



10. Chalk white 12. Light grey 13. Storm grey 15. Slate grey 06. Sand 03. Champagne 11. Sahara Beige

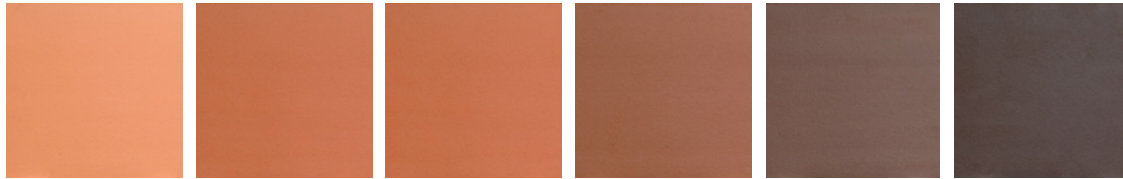

04. Salmon Pink 02. Red-orange 01. Red 07. Siena 09. Coffee 16. Ebony

GLAZED RANGE*



Yellow Lichen Orange Red Mars red Calamine pink Steel

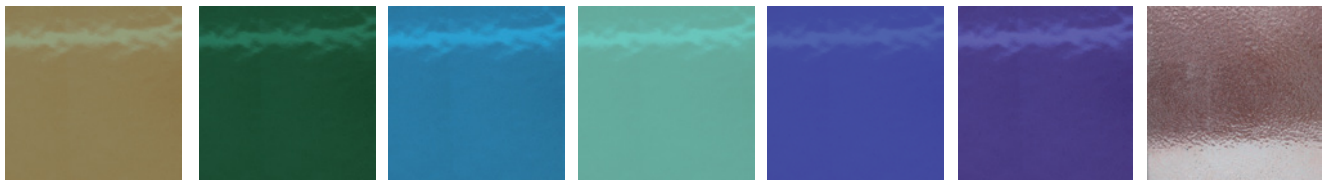

Shadow earth Green Petrol blue Verdigris Cobalt blue Violet Bronze

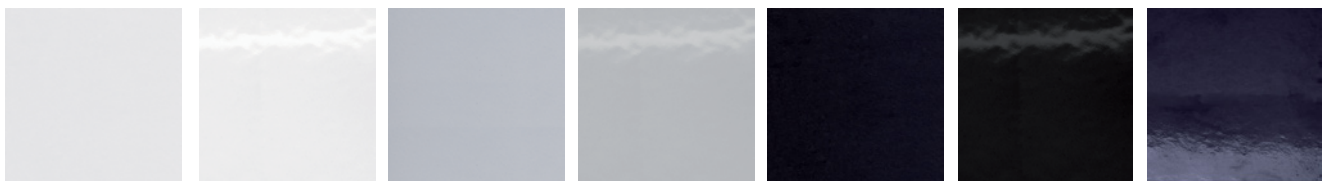

Matt white Glossy white Matt light grey Glossy light grey Matt black Glossy black Marine black

* Glazed finish available for products $H \leq 40$ cm, $L \leq 150$ cm. For other dimensions, contact us

TERREAL can develop custom glazed tints with you. For more information contact us.

TERREAL department façade

Antipolis Bât. B - 37
37, Av Normandie Niemen
BP 13 - 31701 Blagnac

Tel. : +33 (0)5 34 36 21 00
Email : facade@terreal.com

www.terrealfacade.com

TERREAL
Building beauty